

## Verlängerungen

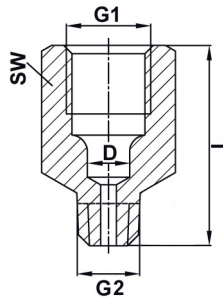

Bezeichnung	Art.-Nr.	G2	G1	L [mm]	SW [mm]
Verlängerung Stahl verzinkt	HE-100-125	M6 x 1	M6 x 1	57,5	9
	HE-2510-102	M6 x 1	M6 x 1	20	9
	HE-100-120	M6 x 1	M8 x 1	18	11
	HE-2510-103	M6 x 1	M10 x 1	23	13
	HE-2510-104	M6 x 1	R1/8	23	13
Verlängerung Stahl verzinkt	HE-100-130	M8 x 1	M8 x 1	18	11
	HE-100-132	M8 x 1	M8 x 1	32	11
	HE-100-135	M8 x 1	M8 x 1	62,5	11
	HE-100-130-1	M8 x 1,25	M8 x 1,25	20	11
	HE-100-132-1	M8 x 1,25	M8 x 1,25	32	11
	HE-100-137	M8 x 1	M10 x 1	23	13
	HE-100-169	M8 x 1	R1/4	22	13
	HE-100-170	M8 x 1	R1/8	23	13
Verlängerung Stahl verzinkt	HE-100-140	M10 x 1	M8 x 1	18	11
	HE-100-142	M10 x 1	M10 x 1	18	13
	HE-100-141	M10 x 1	M10 x 1	23	13
	HE-100-145	M10 x 1	M10 x 1	35	13
	HE-100-143	M10 x 1	M10 x 1	40	13
	HE-100-146	M10 x 1	M10 x 1	50	13
	HE-100-171	M10 x 1	R1/4	22	17
Verlängerung Stahl verzinkt	HE-100-151	R1/8	M10 x 1	18	13
	HE-100-152	R1/8	R1/8	18	13
	HE-100-155	R1/8	M8 x 1	23	13
	HE-100-148	R1/8	R1/8	23	13
	HE-100-156	R1/8	R1/8	30	13
	HE-100-149	R1/8	R1/8	35	13
	HE-100-157	R1/8	R1/8	41	13
	HE-100-154	R1/8	R1/8	45	13
	HE-100-153	R1/8	R1/8	50	13
Verlängerung Stahl verzinkt	HE-100-144	R1/4	M10 x 1	20	17
	HE-100-161	R1/4	R1/4	25	19
	HE-100-186	R1/4	R1/4	85	17
	HE-100-187	R1/4	R1/4	104	17
	HE-100-147	R1/4	R1/8	20	17
	HE-100-162	R1/8	R1/4	22	17
	HE-100-160	R1/4	R 3/8	27	22



# Verschraubungen

## Winkelstücke

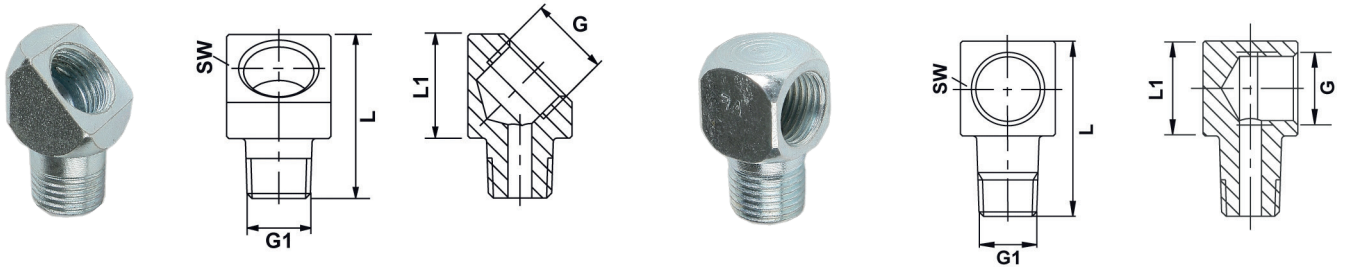

Bezeichnung	Art.-Nr.	G	G1	L [mm]	L1 [mm]	SW [mm]
Winkelstück 45° Stahl verzinkt	HE-100-822	M8 x 1	M8 x 1	23	13	13
	HE-100-833	M10 x 1	M10 x 1	23	13	13
	HE-100-844	R1/8"	R1/8"	23	13	13
	HE-100-855	R1/4"	R1/4"	33	18	17
Winkelstück 90° Stahl verzinkt	HE-100-721	M8 x 1	M6 x 1	23	13	12
	HE-100-722	M8 x 1	M8 x 1	23	13	12
	HE-100-723	M8 x 1	M10 x 1	23	13	12
	HE-100-733	M10 x 1	M10 x 1	23	13	13
	HE-100-744	R1/8"	R1/8"	23	13	13
	HE-100-724	M8 x 1	R1/8"	23	13	12
	HE-100-755	R1/4"	R1/4"	33	18	17